

Dumas Ditch Report

for Crescent Moon Ranch

Spring 2010



This biannual report from the Crescent Moon Ranch Community Garden contains an update on the state of affairs for the United States Forest Service.

Table of Contents

Introduction.....	2
2010 Volunteer Projects.....	2
Repairs Completed.....	2
Repairs to be Made.....	3
Planting List	3
Appendix 1: Map of the Dumas Ditch.....	4
Appendix 2: Plot Map.....	5
Appendix 3: Chris Andersons’s Garden List.....	6

<http://www.crescentmoonranch.org>

Introduction

Spring 2010 has started nicely, due to the gardeners and committed workforce at the garden last fall. While the ditch was closed, we performed many a repair, and were pleased with the results.

Many new gardeners have joined the garden, bringing the total workforce to eight committed individuals.

Additionally, around 50 students from 7 Centers Yoga and Red Rock High School have had a consistent presence at the garden/Dumas ditch.

In March 2010, Crescent Moon Community Garden was also part of the Spring Planting and Pruning Work party open to all. This event was sponsored by Gardens for Humanity and drew in around 20 individuals interested in training for fruit pruning and planting techniques. It was advertised throughout the Sedona area.

Currently, the Dumas Ditch has a strong flow (above normal) due to a good winter's snow. We are expecting that it will be necessary to clean Areas 1 – 2 once the floodwaters recede.

2010 Volunteer Projects

Each year, gardeners have work days in order to maintain the property and their individual plots. This fall, while the ditch was dry, we completed many projects (listed below).

We have and are soliciting help from many local organizations for the necessary labor and materials to maintain and service the Dumas ditch. We are always seeking additional assistance in getting volunteers to clean the ditch.

Repairs Completed

(see Appendix 1 for area map):

- **Area 2:** This area was leaking profusely through existing sandbags and black plastic liners. Volunteers dug this area out, clipped back non native blackberry bushes along and in the ditch and lined with pond liner.
- **Area 5:** This Gunitite section of ditch had substantial cracks large enough to drain the entire contents of the ditch. Volunteers rebuilt this section with 30 60-lb bags of concrete.
- **Area 2-Area 9:** Volunteers cleared bank and ditch trail of noxious non native invasive blackberries. Volunteers also removed sediment deposits on ditch bottom.
- **Area 11:** Recreational Resource Management completed construction of the flume that spans the Schuerman Ditch. The metal superstructure, redwood layer, and folded sheet metal liner allowed for a rustic look & functional flume over the ditch. Repairs done on the flume were completed solely by Recreational Resource Management.

Volunteer Contributions

Spring 2010

- *Total Estimated Volunteer Hours: 768*
- *Total Estimated Contributions: \$445*
 - ❖ *pond liner for Area 2: \$280*
 - ❖ *concrete for Areas 3 & 5: \$165*

Repairs to be Made

- **Repair Field Gates 7 & 8.** This area is leaking into the large field northeast of the garden.
- **Clear ditch in Areas 9–10.** This area poses large problems if any more debris falls into this section of ditch. Because of the congestion caused by the overgrowth and non native species plant life in the ditch, this area is particularly susceptible to ditch overflow. This situation would erode the very foundation of the ditch in this location.

Planting List

The gardeners have been asked to submit their planting lists for inclusion in this report. Geoff Worssam continues to maintain the apple orchard which includes Arkansas Blacks, Fujis, and Galas along with 3-111 root stocks for potential grafting of early varieties. Rob Lautze & Shelly Kidwell have indicated that they are growing onions, peppers, garlic, tomatoes, squash, and potatoes. Ruth Hartung has spearheaded that planting of a large squash bed, along with watermelons. Michael & Patrick Keehn state that they are planting corn, carrots, and wheat. Desert Star School has indicated an interest in planting pumpkins and winter squash. Chris Anderson has the most extensive list; it is attached as Appendix 3.

Appendix 1: Map of the Dumas Ditch

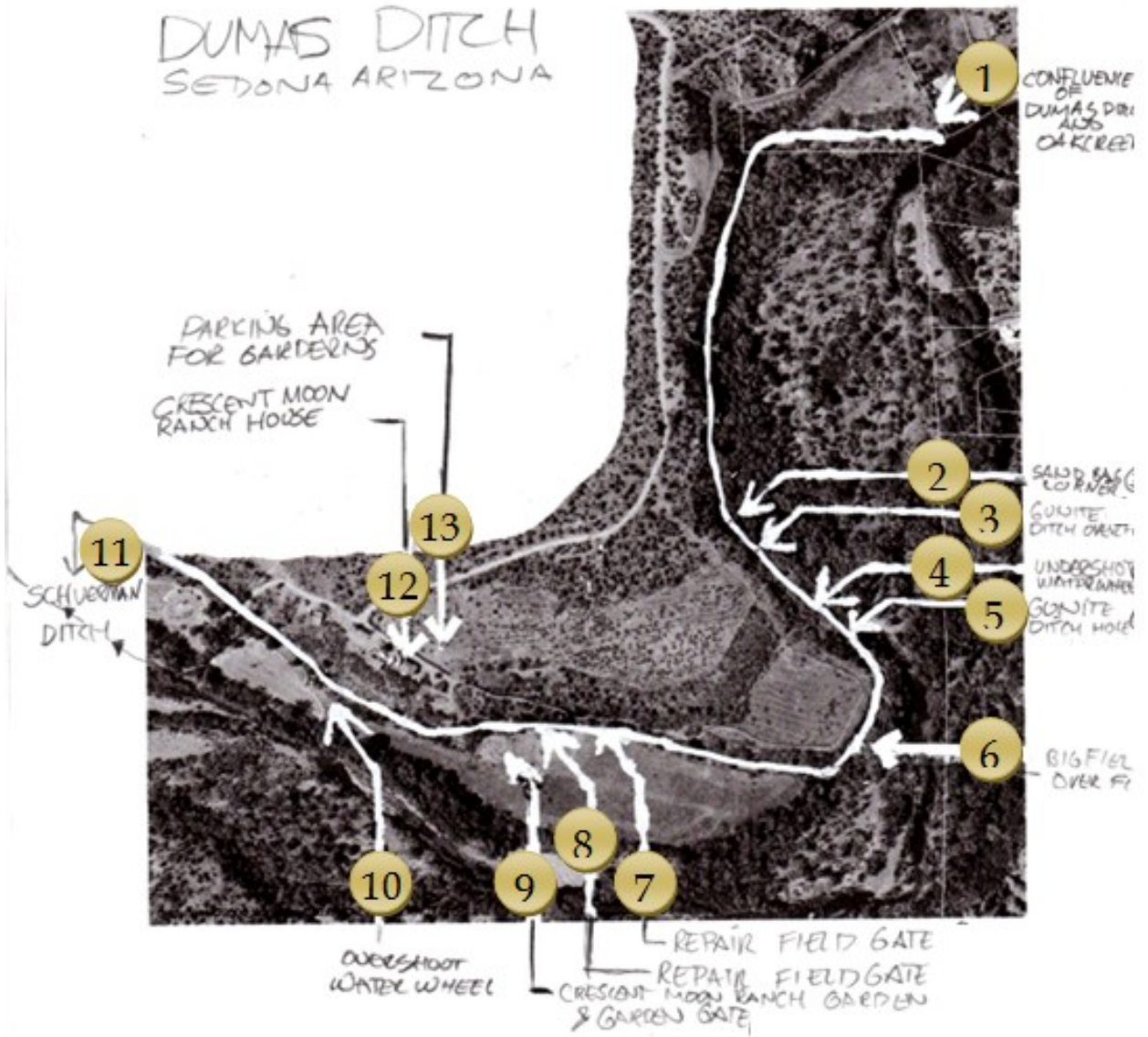

Appendix 2: Plot Map

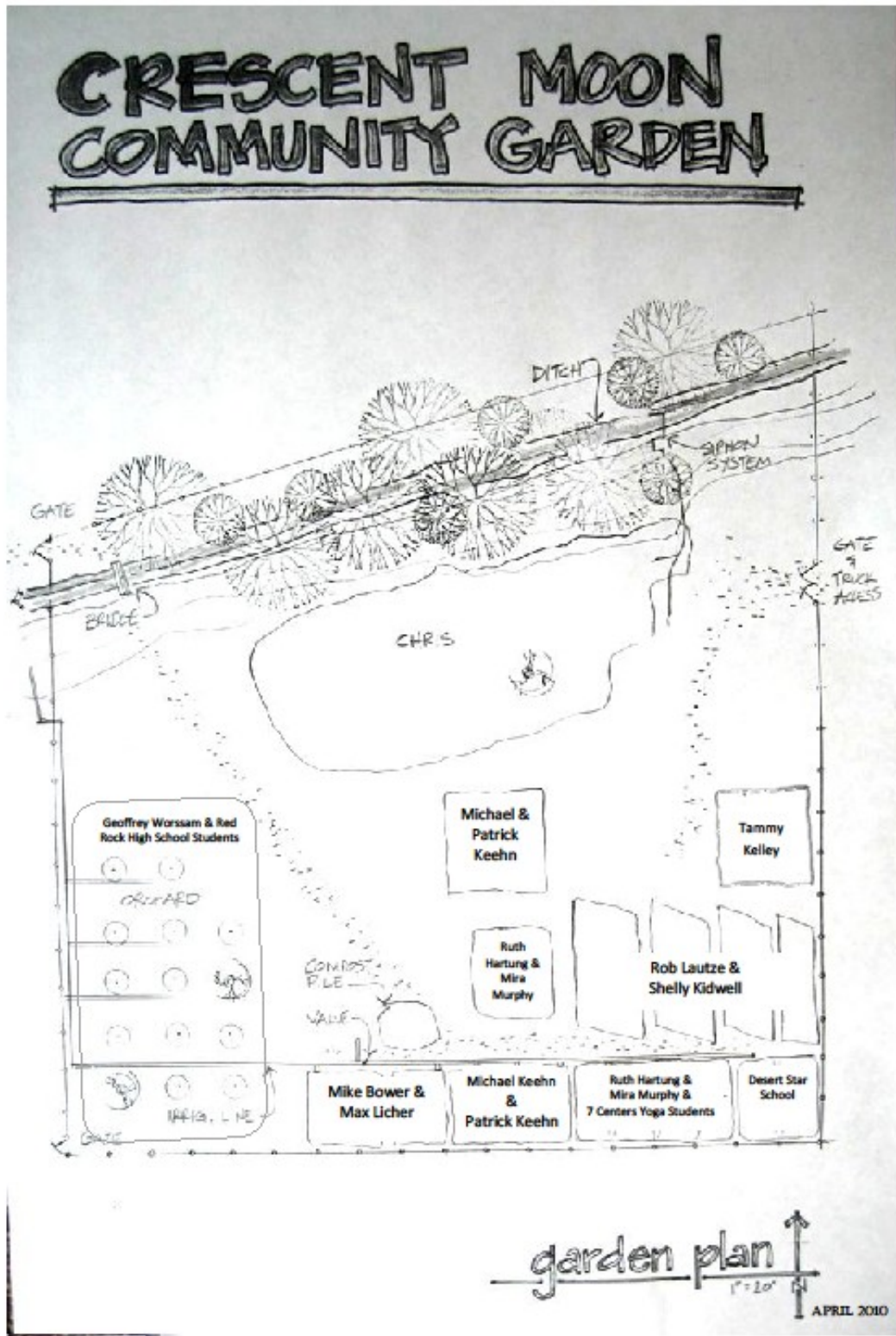

Appendix 3: Chris Anderson's Garden List

Plant List for Community Food Forest at Crescent Moon Ranch

Sedona, Arizona

April 18, 2010

Trees

Apple
Pear
Cherry
Mulberry
Fig
Jujube
Mesquite
Pinyon pine
Walnut
Redbud
Black Locust
Hackberry
Pawpaw
Arizona ash
Burgambel oak
Desert willow

Shrubs

Yellow Bird of Paradise
Currant
American plum
Elderberry
Coffeeberry
Genista pilosa
Germander
Rosemary
Serviceberry
Prunus besseyi
Vitex agnus-castus
Butterfly bush
Pomegranate
Rhus ovate
Rhus glabra
Wolfberry
Catclaw acacia
Apache plume
New Mexican locust
Angelita daisy

Perennials & Self-Seeding Perennials

Yarrow
Monarda
Agastache

Iris
Delphinium
Milkvetch / Locoweed
Echinacea
California poppy
Shasta daisy
Lemon balm
Hollyhocks
Mirabilis
Sedum
Chrysanthemum
Verbena
Snakeweed
Globemallow
Penstemon
Garlic chives
Calendula
Nasturtium
Catmint
Salvia greggii
Salvia
Chrysactinia Mexicana
Tagetes lemmonii
Wallflowers
Day lilies
Sunchokes
Maximillian sunflower
Wild sunflower
Oregano
Thyme
Wild mint (riparian species from Cornville)
Lupines
Rocky Mountain bee plant
Native buckwheat
Garden variety buckwheat
Blue flax
Sego lily
Desert mariposa
Yerba santa
Epasote
Camas
Russian comfrey (sterile), used as mulch plant
and medicinal herb
Oenothera, local species
Yellow sweet clover, naturalized
Alfalfa, naturalized

Perennials & Self-Seeding Perennials,

continued

Desert marigold
Coyote gourd, naturalized
Chocolate flower
Chia
Aster
Purple Prairie Clover

Bulbs

Daffodils
Iris
Alliums
Egyptian Walking Onions
Day lilies
Camas lilies
Crocus

Vegetables & related

Winter squash
Tepary beans
Melons
Corn
Sweet peppers
Hot peppers
Basil
Tomatoes
Globe artichokes
Okra
Eggplant
Sweet potatoes
Devil's claw
I'toni onions
Celeriac
Beets
Radishes

Other

Grapes
Agave
Banana yucca
Mushrooms

Compiled by Chris Anderson _____

Approved by Max Licher _____